

HYWORTH

FORKLIFTS



Watch the
Ride on Reach
Truck in action



1.6T Ride On Reach Truck

H16BERT75

Load capacity
1.6 tonne

Collapsed height
3.180m

Lift height
7.5m

Manoeuvrability

Ease of use





The 1.6T Ride On Reach Truck is perfect for small to medium-sized businesses looking to expand their operations and upgrade from low to high-racking requirements.



The Ride On Reach Truck is equipped with advanced safety features and user-friendly controls, allowing tasks to be performed confidently and with ease.

With state-of-the-art engineering, a modern style design and advanced operator features, the Ride On Reach Truck offers exceptional productivity levels. Combining these features, the Ride On Reach Truck meets the demands of almost every warehouse environment.

The Ride On Reach Truck is handy for warehouses to lift heavy loads in narrow aisles and maximise vertical storage space. Save time and money by reducing the need for additional operators or external storage and maximise your warehouse operations.

User-friendly controls

Easily use the Ride On Reach truck for extended periods with a clear control system and comfortable positioning.

AC regenerative brakes

Reduce the amount of time spent recharging your forklift and store energy in the truck for later use with a highly efficient braking system.

Ample accessory options

Improve functionality, safety, and efficiency with a range of accessories, including fork extensions, side shifters and LED work lights.

Economical

Save energy and cut costs with regenerative braking, efficient motors and controllers and smart battery charging.

Safety & Ergonomics

Low operating noise - Improve communication and create a comfortable working environment with a low operating noise rated at 72 decibels.

Highly visible overhead guard - Lower the risk of injury and accidents with a guard to protect the operator from falling objects while still offering enhanced visibility.

Auto park brake - Ensure the vehicle is safely parked at a stop when exiting the forklift with automatic restriction of the wheels' rotation.

Easy step entry/egress - Reduce fatigue and improve productivity by easily accessing the forklift with a low step height and wide positioning.

Easy battery access - Reduce downtime, with easy access to the battery for quick and seamless replacement and easy battery tracking.

Deadman foot switch - Enhance safety and reduce risks with automatic stopping features in the event that the foot unintentionally touches the pedal.

Efficiency & Productivity

Operator-friendly - Operate easily and comfortably in most work environments with an ergonomic design, easy-to-use controls and adjustable features.

Easy maintenance - Easily maintain this forklift with manufacture-trained service technicians, a user-friendly design and easily accessible components.

Good visibility - Move quickly, safely and efficiently with slim masts and a strategic fork position for maximum visibility.

180-degree steering - Navigate in tight spaces and reduce the risk of collisions with 180-degree steering offering tighter turning and greater manoeuvrability

Economical - Save money and conserve energy with regenerative braking, efficient motors and controllers and smart battery charging.

Serviceability & Reliability

Comprehensive parts inventory - Save money and reduce downtime spent on repairs and maintenance with access to an extensive collection of spare parts.

Periodic servicing - Reduce the risk of unexpected breakdowns with routine maintenance prompted, scheduled and served by our experienced technicians.

Fixed price servicing - Budget for your servicing costs upfront and ensure a consistent, reliable service every time with Hyworth's fixed-priced servicing.

Manufactured-trained service technicians - Have your machine serviced quickly and efficiently by highly trained technicians with the expertise to solve your problem.

3-Year Manufacturer's Parts and Labour Warranty - Avoid out-of-pocket expenses, with the added peace of mind that your machine comes with a 3-year warranty.



Features

Safety

Emergency disconnect switch	Included
Deadman foot switch	Included
Seat switch	Included
Horn and reversing beeper	Included
Flashing light	Included
Auto park brake	Included
Load guard modifications	Optional
Blue safety light	Optional
LED work light	Optional
Panoramic mirror	Optional
Fire extinguisher	Optional
Bluetooth wireless camera	Optional



Performance

AC regenerative brake system	Included
Side-shift function	Included
Tilt function	Included
Slipper extensions	Optional
Longer fork tynes	Optional
Digital weight gauge	Optional

Ergonomics

Lever controls	Included
180-degree steering	Included
Bluetooth wireless camera	Optional





16

HYWORTH

Technical Specifications

Main technical parameters list

	model		H12BERT	H14BERT	H16BERT	H20BERT
Overview	Power form		Accumulator	Accumulator	Accumulator	Accumulator
	Operation type		Seated	Seated	Seated	Seated
	Rated load	Q (kg)	1200	1400	1600	2000
	Load centre distance	c (mm)	600	600	600	600
	Bearing distance	x (mm)	269	269	269	344
	Front overhang	x ₁ (mm)	221	221	221	221
	Wheelbase	y (mm)	1460	1460	1460	1535
	Weight	Service weight	kg	4729	4729	4729
Wheel chassis	Tyre material		PU	PU	PU	PU
	Drive wheel size		Ø343×140	Ø343×140	Ø343×140	Ø343×140
	Bearing wheel size		Ø330×100	Ø330×100	Ø330×100	Ø330×100
	Number of wheels		1×/2	1×/2	1×/2	1×/2
	Wheel base (bearing wheel)	b ₁₁ (mm)	1168	1168	1168	1168
Size	Angle of fork frame (front/rear)	α/β(°)	2/4	2/4	2/4	2/4
	Retracting height of door frame	h ₁ (mm)	5150	5150	5150	5150
	Free lift	h ₂ (mm)	4185	4185	4185	4185
	Overall lifting height	h ₃ (mm)	12500	12500	12500	12500
	Portal height	h ₄ (mm)	13465	13465	13465	13465
	Height of overhead guard	h ₆ (mm)	2200	2200	2200	2200
	Overall length (including fork, retracted mast)	l ₁ (mm)	2509	2509	2509	2509 ¹⁾
	Length from fork end to front (retracted mast)	l ₂ (mm)	1439	1439	1439	1439 ¹⁾
	Total width	b ₁ /b ₂ (mm)	1270	1270	1270	1270
	Fork size	s/e/l (mm)	40/122/1070	40/122/1070	40/122/1070	40/122/1070
	Fork rack type		ISO2328 2A	ISO2328 2A	ISO2328 2A	ISO2328 2A
	Fork rack width	b ₃ (mm)	942	942	942	942

	Support leg width	b ₄ (mm)	940	940	940	940
	Forward distance	l ₄ (mm)	490	490	490	565 ¹⁾
	Ground clearance, wheelbase centre position	m ₂ (mm)	78.5	78.5	78.5	78.5
	Minimum turning radius	W _a (mm)	1725	1725	1725	1800
	Frame length	l ₇ (mm)	1895	1895	1895	1970
Performance parameter	Travel speed full load/no load	km/h	14/14	14/14	14/14	14/14
	Lifting speed full load/no load	m/s	0.450/0.480	0.410/0.480	0.360/0.480	0.330/0.480
	Falling speed full load/no load	m/s	0.510/0.330	0.510/0.330	0.510/0.330	0.510/0.330
	Maximum gradeability full load/no load	%	12/15	12/15	11/15	10/15
Motor and battery	Traction motor S2 60 min	kW	6.4 AC	6.4 AC	6.4 AC	6.4 AC
	Lifting motor at S3 15%	kW	12.8 AC	12.8 AC	12.8 AC	12.8 AC
	Steering motor S2 60 min	kW	0.67 AC	0.67 AC	0.67 AC	0.67 AC
	Battery voltage/ rated capacity K5	V/Ah	48V /460	48V /460	48V /460	48V /600
	Battery weight	kg	939	939	939	1119 ¹⁾
Other data	Control type		INMOTION AC	INMOTION AC	INMOTION AC	INMOTION AC
	Attachment operating pressure	bar	150	150	150	150
	Attachment operation flow (maximum)	l/min	65	65	65	65
	Ear noise, according to standard EN / DIN 12 053	dB (A)	72	72	72	72

Type	Model	Lifting height h ₃	Mast lowered h ₁	Mast extended h ₄		Free lifting height h ₂		Tilting range		Load capacity at 600mm				
				Without backrest	With backrest	Without backrest	With backrest	Forw ard	Back ward	1.2t	1.4t	1.6t	2.0t	
		mm	mm	mm	mm	mm	mm	(°)	(°)	kg	kg	kg	kg	kg
Three-level fully free wide-view mast QAZ0V (Imported channel steel)		5000	2315	5670	5965	1596	1350	2	4	1200	1400	1600	2000	2000 ¹⁾
		5500	2490	6170	6465	1796	1525	2	4	1200	1400	1600	2000	2000 ¹⁾
		6000	2665	6670	6965	1995	1700	2	4	1200	1400	1600	2000	2000 ¹⁾
		6500	2835	7170	7465	2136	1870	2	4	1200	1400	1600	1900	2000 ¹⁾
		7000	3020	7670	7965	2350	2055	2	4	1000	1200	1400	1700	1800 ¹⁾
		7500	3180	8170	8465	2510	2215	2	4	900	1100	1300	1600	1700 ¹⁾
		8000	3350	8670	8965	2680	2385	2	4	850	1050	1250	1550	1650 ¹⁾
		8500	3580	9170	9465	2910	2615	2	4	800	1000	1200	1500	1600 ¹⁾
		9000	3800	9670	9965	3130	2835	2	4	750	950	1150	1450	1550 ¹⁾
		9500	3970	10170	10465	3300	3005	2	4	700	900	1100	1400	1500 ¹⁾
		10000	4100	10670	10965	3430	3135	2	4	650	850	1050	1350	1450 ¹⁾
		10500	4250	11170	11465	3580	3285	2	4	600	800	1000	1300	1400 ¹⁾
		11000	4450	11670	11965	3780	3485	2	4	550	750	950	1250	1350 ¹⁾
		11500	4700	12170	12465	4030	3735	2	4	500	700	900	1200	1300 ¹⁾
	12000	4900	12670	12965	4230	3935	2	4	450	650	850	1150	1250 ¹⁾	
	12500	5150	13170	13465	4480	4185	2	4	400	600	800	1100	1200 ¹⁾	

1) The corresponding load capacity when configuring 750Ah battery

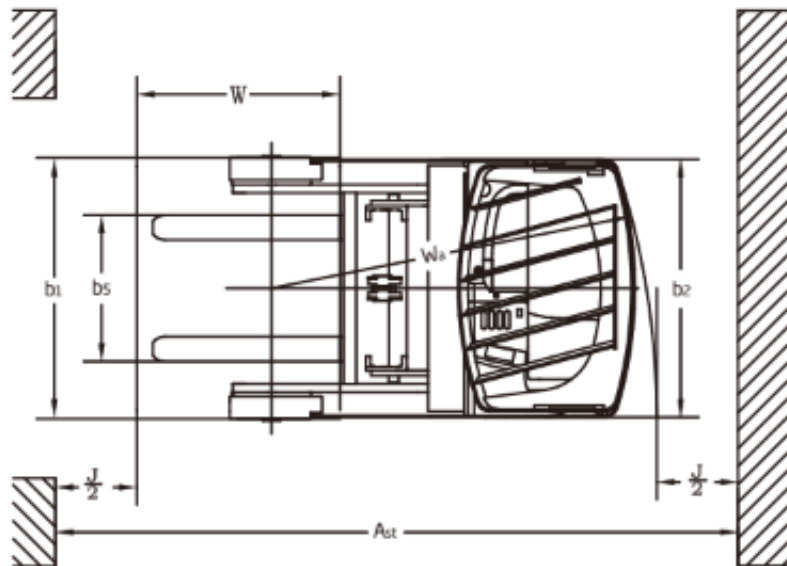
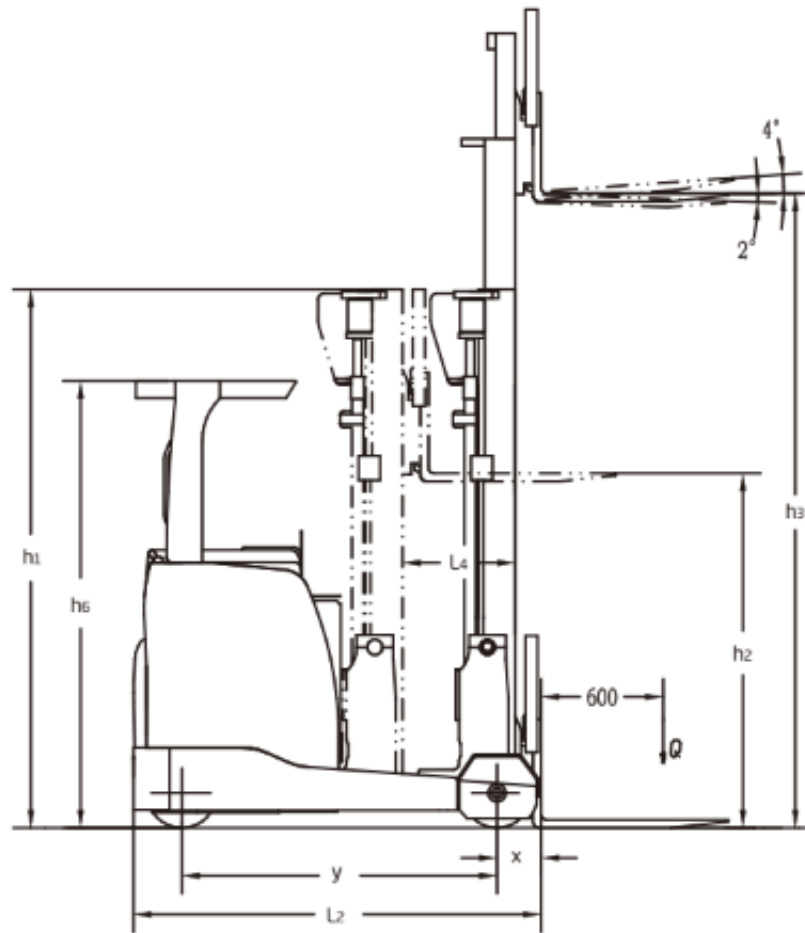

2/12 Weld Street PRESTONS NSW 2170
 1300 HYWORTH (1300 499 678)
 info@hyworthforklifts.com.au
 www.hyworthforklifts.com.au